

PASSIVE CLIP SLING

ARJOHUNTLEIGH

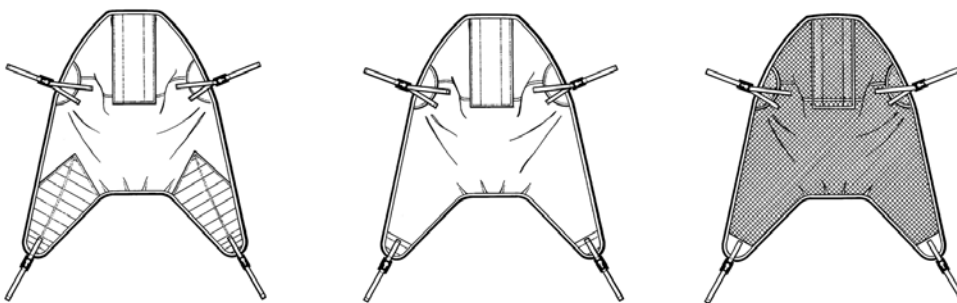

Operating and Product care Instructions

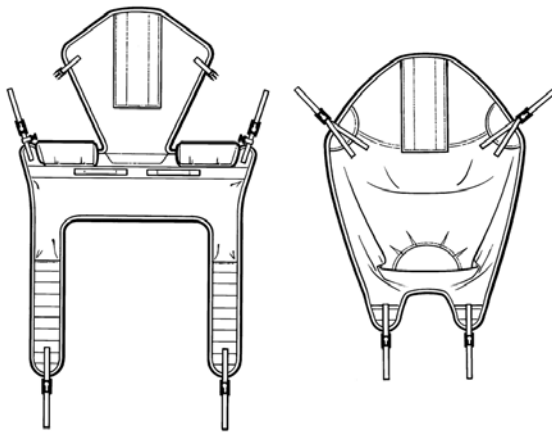

MAX81785-M-INT
issue 1
november 2008

Important information

COMPONENTS OF A SLING

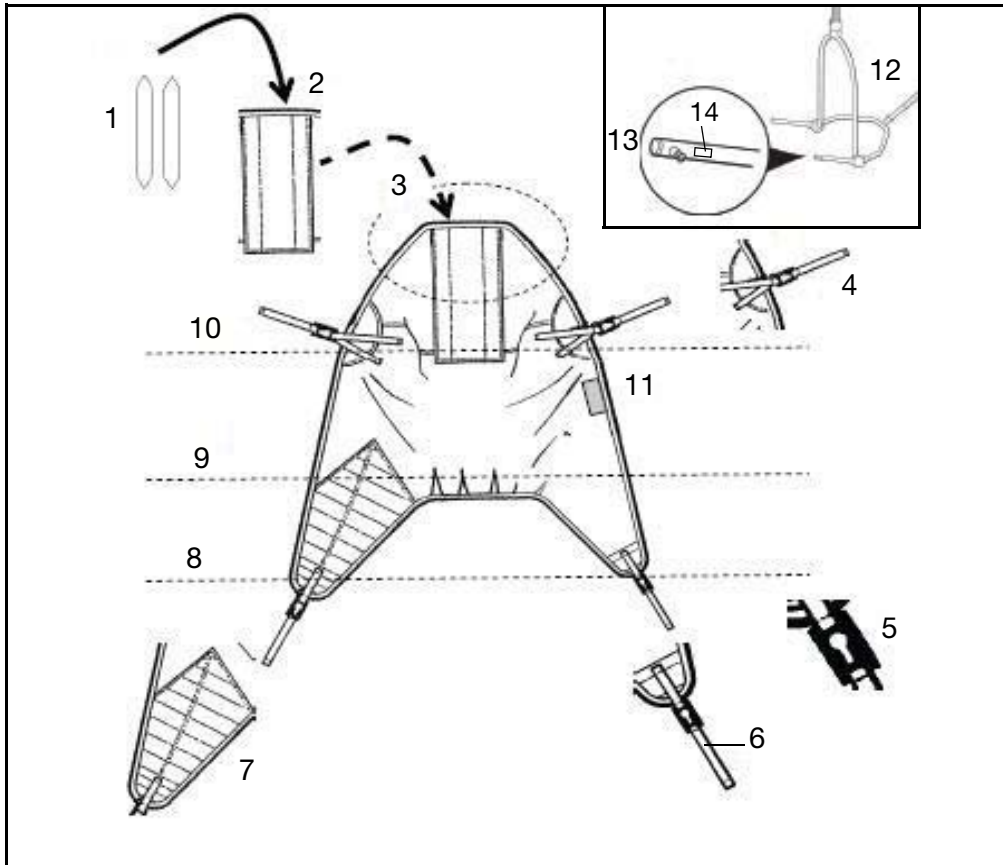
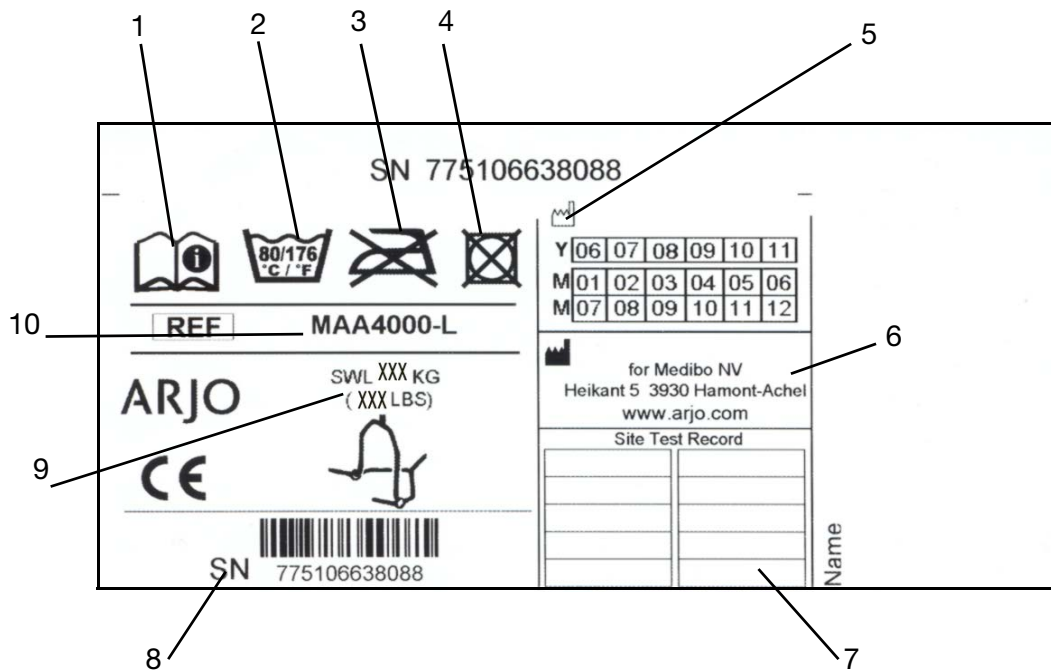

Fig. 1

EXAMPLE OF A SLING LABEL



This label is only used as a reference and is not representative for this sling.

Fig. 2

Important information

Operational life



The operational life of the sling is dependent on the actual use conditions. Therefore, before use, always make sure that the sling straps do not show signs of fraying, tearing or other damage and that there is no damage (i.e cracking, bending, breaking) to the attachment clips. If any such damage is observed, do not use the sling. If you have any doubts about sling safety, as a precaution and to ensure safety, do not use the sling.

Components of a sling (See page 1, fig. 1)

1. Stiffener
2. Stiffener pocket
3. Head piece
4. Shoulder strap
5. Attachment clip
6. Leg strap
7. Leg piece with padding
8. Leg section
9. Body section
10. Head section
11. Sling label
12. Spreader bar (lift component)
13. Attachment lug (lift component)
14. Label for correct clip attachment

Information on Label (See page 1, fig. 2)

1. Stop and read operating instructions before using this sling.
2. Maximum washing temperature °C (°F) / See sling label
3. Do not iron
4. Do not tumble dry
5. Manufacturing date
6. Manufacturer
7. Specification sheet
8. Serial number
9. Maximum weight to be lifted in kilograms: XXX kg/lbs
10. Article number

Intended use

- ArjoHuntleigh clip slings are intended to be used with ArjoHuntleigh lifters equipped with clip hanger bars only. The right type and size of slings should be used after proper assessment of each resident's size, condition and the type of lifting situation.
- ArjoHuntleigh clip slings must only be used by appropriately trained caregivers with adequate knowledge of the care environment, its common practices and procedures and in accordance with the guidelines in these instructions.

Before use



- **Use the sling according to both the lift and sling Operating and Product Care Instructions.**
- ArjoHuntleigh will not be held responsible for product changes that are not approved by ArjoHuntleigh.
- **Do not use slings with attachment clips on spreader bars with hooks. Do not use slings with attachment loops on spreader bars with attachment lugs.**
- ArjoHuntleigh slings with head support have two pockets at the head section. The pockets must contain plastic stiffeners when using the sling.
- Make sure that the sling is not attached to any object other than the hanger bar attachment lugs of the lift. If the sling is attached improperly, the weight that is put on the sling will increase and surpass the maximum allowed weight. This may cause damage to the attachment clips.
- A clinical assessment should be carried out by a qualified nurse and therapist before lifting residents.
- Special attention should be paid to residents prone to spasms or unexpected movements as they can inadvertently kick off the leg attachment clip
- Residents with implanted medical devices, e.g. artificial stomata or other applications where the implanted medical device can come into contact with the sling, shall not be lifted.
- **The slings should be checked before and after use with each resident and, if necessary, washed according to instructions on the sling. This is especially important when using the same equipment for another resident, to minimize the risk of cross infection.**
- Inspect the sling on a flat surface so that all areas of the sling are visible.

Sling Sizing Guide

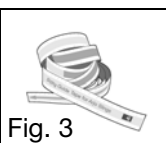

Fig. 3

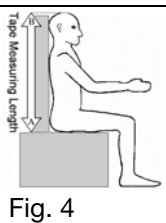

Fig. 4

- The sling size should comply with the resident's body shape and disabilities.
- Ensure that the measurement tape (see Fig. 3) with article number MTA1000, is used the correct way (Teal (seaweed green) colour - XXS at the coccyx (spine)).
- Ideally, the resident should be in a seated position (See Fig. 4).
- Measure from the coccyx to the top of the head. The colour level at the top indicates the required size.
- If the size falls between two sizes, always use the smallest size.
- Resident width and body proportions should also be considered and a professional judgment made.
- This sizing tool is only intended as a guide and is an approximation. Other factors like the resident's physical disabilities, weight distribution and general physique all need to be taken into consideration.
- If you have any further questions on the use of the measurement tape, contact your ArjoHuntleigh Sales Company. Contact data can be found on the last page of these instructions.

Important information

Operating instructions (Guidelines during use)



- When fitting the sling, make sure that the sling label is positioned on the outside of the sling and not against the resident's body.
- Proper body mechanics and sound ergonomic positioning should be maintained by the caregiver during use of the sling.
- To position the resident, use the parts of the lifting device designed for the purpose and avoid touching the resident or the sling. Do not use the sling straps while the resident is suspended in the sling.
- Ensure that the straps connecting the sling to the attachment clips are not twisted when the attachment clips are connected to the spreader bar.
- If a toilet sling is used, use it with caution. Encourage the resident to hold on tightly to the sling to avoid sliding out. Do not use the toilet sling for lifting and transportation apart from toilet related situations.
- **Always check that the sling attachment clips are fully in position before and during the commencement of the lifting cycle, and in tension as the resident's weight is gradually taken up. Always check that the clip is mounted on the attachment lugs in its most downward position (See Fig. 5 & 6).**

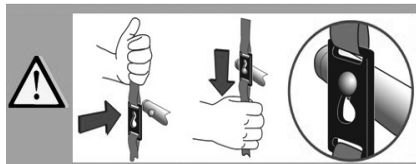

Fig. 5



Visit our website: www.arjohuntleigh.com to view an instructional video on how to attach the sling correctly to the attachment lugs on the spreader bar. You can also download an instruction poster or order it free of charge through your Sales Organization. The contact data can be found on the last page of these instructions.

Product care instructions (Guidelines after use)



- All sling straps should be checked, and if necessary, washed. Washing and drying temperatures must be according to the label instructions. Wash using normal detergents; do not iron.
- Mechanical pressure is not allowed during the washing and drying procedure, e.g. rolling or pressing, as this can damage parts vital to the safe and comfortable operation of the sling.
- With regard to laundering, slings should not be classified as linen, but as an accessory to a resident transfer lifter. Slings should be cleaned and disinfected only in strict accordance with the manufacturer's instructions.

Washing instructions

Before washing: Remove the plastic stiffeners, if applicable, from the pockets in the sling. Place them back in their pockets before use.

Chemical decontamination: Sodium hypochlorite 150-300ppm in low temperature wash.

Thermal disinfection: Wash at maximum 80°C (176°F) for at least three minutes.

DO NOT USE: IODINE BASED DISINFECTANTS - GAS STERILIZATION - AUTOCLAVE

DO NOT USE MECHANICAL PRESSURE: PRESSING OR ROLLING, DURING THE WASHING OR DRYING PROCEDURES.

Sling storage

Slings should be stored away from direct sunlight where they are not subject to unnecessary strain, stress or pressure, or to excessive heat or humidity. The slings should be kept away from contact with sharp implements, corrosives or other possible causes of damage.

ArjoHuntleigh strongly advise and warn that only ArjoHuntleigh designated parts, which are designed for the purpose, should be used on equipment and other appliances supplied by ArjoHuntleigh, to avoid injuries attributable to the use of inadequate parts. The Company's Conditions of Sale make specific provision confirming no liability in such circumstances. The policy of ArjoHuntleigh is one of continuous development, and we therefore reserve the right to change specifications without notice.

The illustration below is affixed to the lift's spreader bar and means:
Ensure that the clip is mounted on the attachment lug in its most downward position.

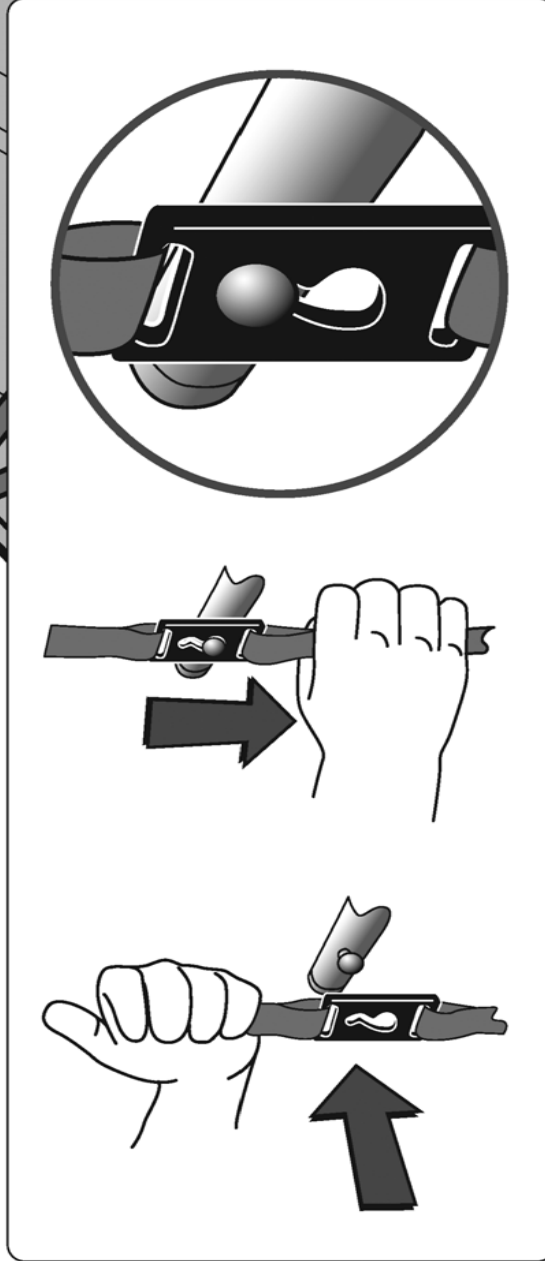

Fig. 6

POSTER

ARJOHUNTLEIGH

CLIP SLING / FLITES



www.arjohuntleigh.com



AUSTRALIA

Arjo Hospital Equipment Pty Ltd
 Unit1, 205 Queensport Road
 Murrarie Qls, AU-4172
 Email: info@arjo.com.au
 Tel: +61 7 3395 6311
 Fax: +61 7 3399 3811

SVERIGE

Arjo Scandinavia AB
 Box 61, Verkstadsvägen 5
 SE-241 21 Eslöv
 Email: kundservice@arjo.se
 Tel: +46 413 645 00
 Fax: +46 413 189 73

DANMARK

Arjo Scandinavia
 Postboks 51, 4632 Bjæverskov
 Email: kundservice@arjo.se
 Tel: +45 93 27 37
 Fax: + 45 93 27 39

NORGE

Arjo Scandinavia
 Ryenstubben2, 0679 Oslo
 Email: kundservice@arjo.se
 Tel: +98 28 11 70
 Fax: +22 57 06 52

BELGIË / BELGIQUE

ArjoHuntleigh NV / SA
 Evenbroekveld 16
 B - 9420 Erpe Mere
 Email: info@ArjoHuntleigh.be
 Tel: +32 (0) 53 60 73 80
 Fax: +32 (0) 53 60 73 81

CANADA

Arjo Canada Inc.
 1575 South Gateway Road
 Unit C, Mississauga, Ontario
 L4W 5J1
 Email: info@arjo.ca
 Tel: +1 905 238 7880
 Fax: +1 905 238 7881

CESKA REPUBLIKA

Arjo Hospital Equipment s.r.o.
 Hlinky 118
 603 00 Brno
 Tel: +420 549 254 252
 Fax: +420 541 213 550

DEUTSCHLAND

ArjoHuntleigh GMBH
 Peter-Sander-Strasse 10
 D-55252 Mainz-Kastel
 Email: info@arjo.de
 Tel: +49 6134 1860
 Fax: +49 3167 186 160

ESPAÑA

ArjoHuntleigh Ibérica S.L.
 Carretera de Rubi, 88, 1ª -A1
 08130 Sant Cugat del Valles
 Barcelona
 Email: promo@ArjoHuntleigh.com
 Tel: +34 93 583 1120
 Fax: +34 93 583 1122

FRANCE

Arjo Equipements Hospitaliers SA
 Avenue de l'Europe, 45
 EUROCIT BP 133
 FR-59436 Roncq Cédex
 Email: info@arjo.fr
 Tel: +33 (0)3 20 28 13 13
 Fax: +33 (0)3 20 28 13 14

GREAT BRITAIN

Arjo Med AB Ltd
 St. Catherine's Street
 Gloucester, GL1 2SL
 Email: uksales@arjo.co.uk
 Tel: +44 1452 4282 00
 Fax: +44 1452 4283 44

IRELAND

ArjoHuntleigh Ireland Ltd
 Sydenham Business Park
 Unit 16-18
 19 Heron Road
 Belfast BT3 9LE
 Email: Belfast@arjo.co.uk
 Tel: +44 2890 502000
 Fax: +44 2890 502001

HONG KONG

Arjo Far East Limited
 Room 3A, 4/F Block B
 Hoi Leun Industrial Centre
 55 Hoi Yeun Road
 Kwun Tong, Kowloon
 Tel: +852 2508 9553
 Fax: +852 2389 5797

ITALIA

ArjoHuntleigh S.P.A.
 Via Tor Vergata, 432
 Roma, IT-00133
 Email: promo@ArjoHuntleigh.it
 Tel: +39 06-87426214
 Fax: +39 06-87426222

NEDERLAND

Arjo Nederlands BV
 De Blomboogerd 8
 NL-4003 BX Tiel
 Postbus 6116, 4000 HC Tiel
 Email: info@ArjoHuntleigh.nl
 Tel: +31 344 640 800
 Fax: +31 344 640 885

ÖSTERREICH

ArjoHuntleigh GmbH
 Dörrstr. 85
 6020 Innsbruck
 Email: office@arjo.de
 Tel: +43 512 20 4160-0
 Fax: +43 512 20 43 60 75

POLSKA

ArjoHuntleigh Polska Sp. Z.o.o.
 Ul.Ks. Wawrzyniaka 2
 PL 62-052 Komorniki
 Email: international@arjo-huntleigh.com
 Tel: +48 61 662 1550
 Fax: +48 61 662 1590

SCHWEIZ / SVIZZERA

ArjoHuntleigh AG
 Florenzstrasse 1D
 CH-4023 Basel
 Email: arjo.sic@arjo.ch
 Tel: +41 61 337 97 77
 Fax: +41 61 311 97 42

USA

Arjo, Inc
 50 North Gary Avenue
 Roselle, IL 60172
 Tel: +1-800-323-1245
 Fax: +1-888-594-ARJO(2756)

www.arjohuntleigh.com



© Medibo Medical Products NV
 Heikant 5, Hamont Achel
 Belgium

If your country is not listed here,
 please contact your local distribu-
 tor, or ARJO International AB, Box
 61, S-241 21 ESLÖV, SWEDEN.
 Tel +46 413 64500.
 Fax +46 413 555586.

ARJOHUNTLEIGH

GETINGE GROUP is a leading global provider of equipment and systems that contribute to quality enhancement and cost efficiency within health-care and life sciences, equipment, services, and technologies are supplied under the brands ARJO for resident hygiene, resident handling and wound care, GETINGE for infection control and prevention within healthcare and life science and MAQUET for surgical workplaces, cardiopulmonary and critical care.